

MH 高溫排煙馬達

**High Temperature Resistant
Low Voltage Three-phase Squirrel-Cage Induction Motor**

Certified by TÜV SÜD PSB; 2 hours at 300°C and 400°C
Complied with BS 7346:Part 2:1990

"Specification for powered smoke and heat exhaust ventilators"

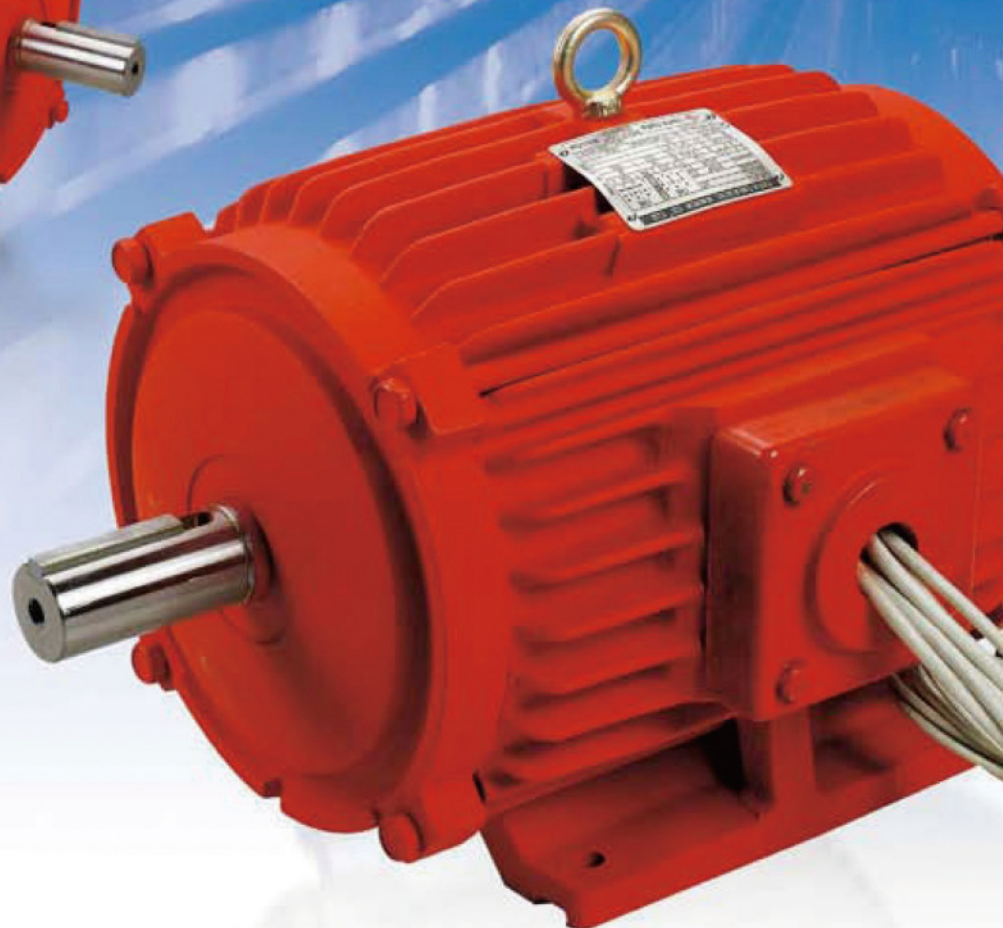
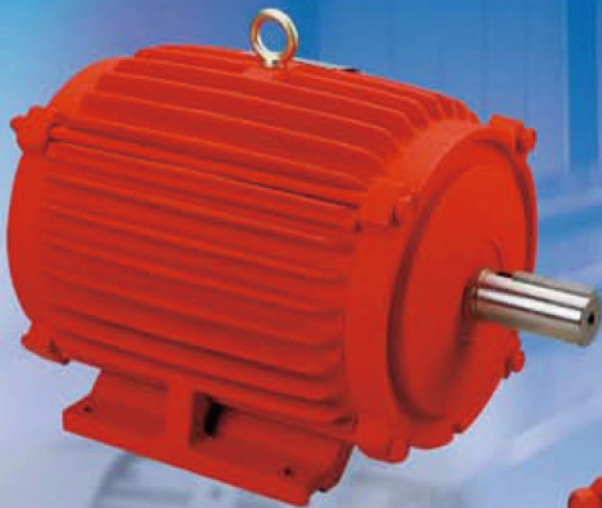

**High Efficiency
IP44 / IP55 Protection
IEC Dimension
Low noise**

OMKSO MOTOR

Introduction

High Temperature Resistant Motors are specially designed for demanding and critical applications, such as fire emergencies in built-up areas. These motors play a life-saving role in the swift extraction and clearance of smoke and toxic fumes at high temperatures during emergencies to reduce casualties as well as facilitate the rescue operations.

These motors are compliant to BS 7346 : Part 2 : 1990 "Specifications for powered smoke and heat exhaust ventilators."

These motors are also built to comply with the requirements for European "CE" marking and International Electrotechnical Commission - IEC 60034 (included 60034-1, 60034-5, 60034-7, 60034-8, 60034-9, 60034-11,60034-12 and 60034-14). Compliance with IEC60034 indicates that these motors also comply with many standards from other countries that are based on IEC60034

Class of performance in accordance to BS 7346 : Part 2 : 1990 Specifications for powered smoke and heat exhaust ventilators

Class	Temperature (C)	Duration(hr)
A	150	5
B	250	2
C	300	0.5
D	300	1
E	400	2
F	600	1.5
G	650	1
H	840	Achieved in 0.5hr (no rated duration)

Time Rating

Continuous rating S1 to IEC 60034 , BS 4999 and AS 1359 part 30 with follow-up emergency rating to 250°C for 180 mins, 300°C for 60 mins or even up to 400°C for 60 mins in accordance to BS 7346 : Part 2 : 1990

Bearing and Lubrication System

Anti-friction ball-bearings with heat resistant silicon thickened grease.

Finish

Phenolic rustproof base plus lacquer surface finish painting in red colour.

Altitude

Standard motros : Max 1,000m above sea-level. Special requirements can be made upon request.

- 高溫排煙馬達應用漁火災發生於建築物內時，能快速排出高溫濃煙及有毒氣體，在逃生過程中，扮演極重要之保命設備。
- 高溫排煙馬達設計及製造符合BS 7346 Part 2，1990 動力煙熱排放通風機規範。
- 符合CE Mark 認證及IEC60034
(包括60034-1，60034-5，60034-7，60034-8，60037-9，60034-12，60034-14)
- **運轉時間：**
在250度，運轉2小時，符合IEC 60034，BS 4999，AS 1359 part 30 規範。
在300度，運轉1小時；或在400度，運轉2小時，符合BS 7346 part 2，1990
- **框架與托架：**
框架與托架由鑄鐵製成，抗蝕性優良，馬達壽命長。
- **定子繞組與絕緣系統：**
定子採用高級絕緣冷軋矽鋼片積片而成，適用高效率。
定子繞組採用耐高溫瓷釉塗層銅線及H級絕緣系統。
出口線採用耐熱矽橡膠絕緣電線。
- **轉子組立：**
轉子採用低耗損的高級電磁鋼板積片製成轉子。
由高導電率鋁壓力鑄造製成，端環與鋁葉一體成型。
轉子經過動平衡校正，表面經過防鏽處理。
- **軸承與潤滑系統：**
抗磨擦滾珠軸承，使用耐熱矽質或氟素化合物油脂。
- **馬達可加裝鋁合金風葉及風扇蓋**
- **軸：**
軸的材料為中碳鋼S45C (JIS G4051)。
- **銘牌：**
由耐蝕不鏽鋼製成。
- **塗裝噴漆：**
表面噴防鏽漆，再噴耐高溫紅色面漆。
- **適用海拔高度：**
適用海拔高度在1000m以下。
- IP44/IP55/IP65



PERFORMANCE DATA

60Hz

Rate Power		Pole	Rated	Frame	Current		Efficiency			Power Factor			Torque			M of IJ
KW	HP		(rpm)		INL 220 (A)	IFL 380 (A)	100%	75%	50%	100%	75%	50%	Full load (Nm)	Locked	Maximum	(Kgm ²)
0.75	1	2	3335	80	2.91	1.7	76.5	76.5	73.5	88.0	82.5	73.0	0.216	250	300	0.005
		4	1710	80	3.50	2.0	77.0	75.5	71.5	78.0	68.5	55.5	0.430	290	300	0.009
		6	1130	90L	3.55	2.1	76.5	76.0	72.5	72.0	63.0	50.0	0.642	200	250	0.017
1.5	2	2	3395	90L	5.53	3.2	80.0	80.5	78.0	88.5	83.5	73.5	0.428	320	330	0.0100
		4	1735	90L	6.00	3.5	80.1	79.5	76.5	80.5	72.5	61.0	0.815	250	300	0.0170
		6	1130	100L	6.60	3.9	77.0	77.5	74.5	77.0	69.5	58.0	1.285	200	240	0.0330
2.2	3	2	3425	90L	7.68	4.6	84.0	84.5	83.5	91.0	87.5	80.0	0.636	320	370	0.0150
		4	1735	100L	8.70	5.0	84.0	82.5	80.0	86.0	80.5	70.5	1.270	240	280	0.0330
		6	1145	112M	9.24	5.4	81.0	81.0	78.5	78.5	71.5	60.5	1.902	190	260	0.0590
3.7	5	2	3485	112M	12.9	7.4	84.5	86.0	83.5	90.0	88.5	82.0	1.041	240	340	0.038
		4	1745	112M	14.5	7.8	87.0	85.5	83.0	85.0	80.0	70.0	2.080	220	200	0.059
		6	1160	132M	15.1	8.7	84.0	83.0	79.5	77.0	69.5	58.0	3.129	180	230	0.151
5.5	7.5	2	3490	132S	18.9	11.0	86.5	86.0	84.0	90.0	88.5	83.5	1.560	210	270	0.0650
		4	1750	132S	20.1	11.6	86.0	85.5	83.5	86.0	80.5	70.0	3.129	240	300	0.1040
		6	1150	132M	21.5	12.8	85.5	85.0	82.5	80.0	73.5	62.5	4.734	210	320	0.2170
7.5	10	2	3475	132S	24.6	14.2	88.0	88.5	87.0	90.5	89.0	84.5	2.089	220	260	0.0760
		4	1750	132M	25.1	14.5	89.5	89.0	87.5	89.0	85.5	77.0	4.172	240	290	0.1430
		6	1170	160M	27.3	16.2	86.5	85.5	82.5	83.0	77.5	68.0	6.204	270	300	0.4000
11	15	2	3535	160M	36.9	21.4	88.0	87.5	85.0	90.5	88.5	83.5	3.080	240	310	0.1470
		4	1760	160M	36.1	21.2	90.5	89.5	87.5	88.5	85.5	78.0	6.204	240	290	0.3150
		6	1165	160L	40.0	22.5	89.0	88.5	86.5	82.5	76.5	65.5	9.346	290	320	0.5880
15	20	2	3515	160M	48.1	27.8	88.5	88.0	86.0	92.0	91.5	88.5	4.130	230	260	0.1830
		4	1760	160L	49.1	29.0	91.0	91.0	90.0	89.5	86.0	79.0	8.248	240	270	0.3810
		6	1165	180MC	50.9	29.6	90.5	91.0	90.5	85.0	82.5	76.0	12.461	210	230	1.2330
18.5	25	2	3515	160L	58.5	35.1	90.0	90.0	88.0	93.0	92.5	89.5	5.163	260	270	0.2370
		4	1765	180MC	62.1	36.3	91.5	92.0	91.0	87.5	85.0	78.5	10.370	230	260	0.5710
		6	1170	180LC	64.0	37.2	91.0	91.5	90.5	84.0	80.5	73.5	15.510	210	240	1.6100
22	30	2	3530	180MC	70.2	41.6	91.5	91.0	88.5	91.5	90.0	86.0	6.169	230	270	0.2830
		4	1765	180MC	73.2	42.1	92.0	91.5	90.5	86.0	81.5	72.5	12.373	270	300	0.7440
		6	1170	180LC	75.5	44.3	92.0	92.5	92.0	84.5	82.5	76.5	18.612	210	240	1.9200
30	40	2	3545	180LA	95.8	54.9	90.0	89.0	86.5	89.0	88.0	84.5	8.190	160	230	0.5210
		4	1765	180LC	96.2	55.8	92.5	92.0	91.0	88.0	85.5	80.0	16.404	260	280	1.2640
37	50	2	3545	200LA	119	69.9	91.5	91.0	89.0	90.0	89.5	86.5	10.238	160	230	0.6330
		4	1770	200LC	124	71.6	92.0	93.0	92.0	86.0	85.5	81.5	20.504	240	250	1.422
45	60	4	1765	200LC	144	83.1	92.0	93.0	92.5	89.0	87.0	84.0	24.675	210	230	1.643
		6	1180	225SC	148	85.4	92.5	93.0	92.0	86.0	84.0	76.5	36.908	220	220	3.023
55	75	4	1775	225SC	184	106	92.5	93.5	92.0	86.5	85.5	79.5	30.670	180	200	1.979
		6	1175	A250SC	185	107	93.0	93.5	93.0	85.5	85.0	78.0	46.331	200	200	4.929
75	100	4	1775	A250SC	235	135	93.5	92.5	91.0	89.0	87.0	83.0	40.893	170	270	4.226

Data are subjected to revisions without any prior notice.

規 範 表

項 目		標 準 規 範
規 格	種 類	低壓三相鼠籠式感應電動機
	設 計 依 據	英國工業標準(BS) 澳洲標準(AS), 中國國家標準(CNS14400)符合電動機規範章節16221 要求
	電 壓	額定電壓 220V / 380V / 415V / 440V / 460V
	頻 率	額定頻率 50 HZ 或 60 HZ
	輸 出 馬 力	2P:1~100HP 4P:1~100HP 6P:1~100HP 8P:1~100HP
	同 步 轉 速	3600~750 R. P. M.
	時 間 額 定	連續使用額定，使用係數S.F.1.0.(50 HZ)/S.F.1.15(60HZ) 緊急下額定：等級D=300 C，90分鐘 D=300 C,60分鐘，D=300 C,120分鐘 D=400 C,120分鐘
	框 號	80~250SC
	保 護 方 式	全密閉（表面風冷）
	絕 緣 等 級	H級
適 用	電 源	電壓變動率：±5%以內
	場 所	一般屋內
	溼 度	相對濕度90%以下（但不能凝結）
	標 高	海拔 1000 公尺以下
	帶 動 方 式	風扇直結傳動
	轉 向	雙轉向
	起 動 方 式	全壓直接啓動或 Y-△啓動

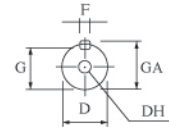
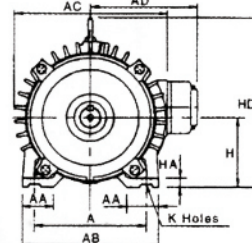
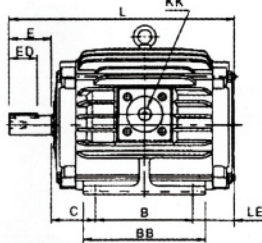
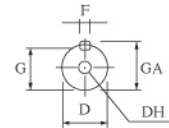
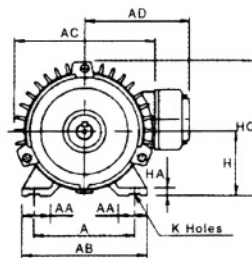
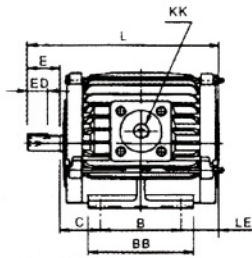

單位：mm

輸出馬力(HP)				框號	圖號	A	AA	AB	AC	AD	B	BA	BB	C	H	HA	HC	HD	DH
2P	4P	6P	8P			D	E	ED	EE	F	G	GA	負載側	反負載側	概略重量				
1	1			80	1	125	35.5	155	174	129	100	-	130	50	80	9.0	168	-	M6X12
2-3	2	1		90L		140	35.5	170	200	142	125	-	150	56	90	10.0	190	-	M8X16
	3	2	1	100L	2	160	45.0	195	219	151	140	-	175	63	100	12.5	-	243	M10X20
5	5	3	2	112M		190	45.0	224	238	161	140	-	175	70	112	14.0	-	265	M12X24
7.5-10	7.5	5	3	132S	2	216	45.0	250	273	178.5	140	-	175	89	132	16.0	-	310	M12X24
	10	7.5	5	132M		216	45.0	250	273	178.5	178	-	212	89	132	16.0	-	310	M12X24
15-20	15	10	7.5	160M	3	254	50	300	334	217	210	-	250	108	160	18.0	-	377	M16X32
25	20	15	10	160L		254	50	300	334	217	254	-	300	108	160	18.0	-	377	M16X32
	25-30	20	15	180MC	3	279	75	355	382	242	241	-	297	121	180	20.0	-	421	M20X40
	40	25-30	20	180LC		279	75	355	382	242	279	-	335	121	180	20.0	-	421	M20X40
50-60				200LA	3	318	80	400	420	265	305	-	365	133	200	25.0	-	469	M20X40
	50-60	40-50	25-30	200LC		318	80	400	420	265	305	-	365	133	200	25.0	-	469	M20X40

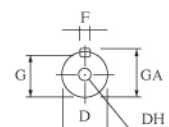
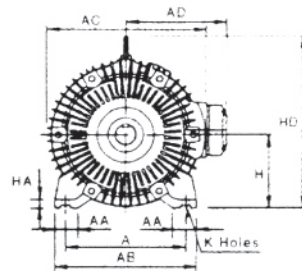
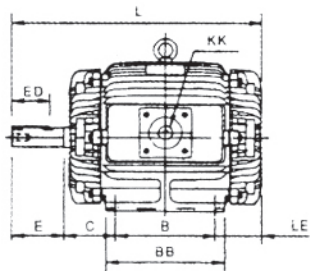

單位：mm

圖號	K	KK	L	LE	軸端							軸承		概略重量	
					D	E	ED	EE	F	G	GA	負載側	反負載側		
1	10	M20XP1.5	236	46	19	40	25	-	6	15.5	21.5	6204ZZC3	6203ZZC3	15	
			283	52	24	50	32	-	8	20.0	27.0	6205ZZC3	6204ZZC3	24	
2	12	M20XP1.5	322	59	28	60	40	-	8	24.0	31.0	6206ZZC3	6205ZZC3	31	
			M25XP1.5	336	66	28	60	40	-	8	24.0	31.0	6306ZZC3	6305ZZC3	43
				393	84	38	80	64	-	10	33.0	41.0	6308ZZC3	6306ZZC3	67
3	14.5	M32XP1.5	431	84	38	80	64	-	10	33.0	41.0	6308ZZC3	6306ZZC3	78	
			525	97	42	110	80	-	12	37	45	6309ZZC3	6307ZZC3	113	
			569	97	42	110	80	-	12	37	45	6309ZZC3	6307ZZC3	143	
		M50XP1.5	580	108	48	110	80	-	14	42.5	51.5	6311ZZC3	6310ZZC3	165/185	
			618	108	55	110	80	-	16	49	59	6312ZZC3	6310ZZC3	220	
18.5	M50XP1.5	715	135	55	110	80	-	16	49	59	(6312C3)	(6212C3)	269		
		60	140	110	-	18	53	64	6314C3	6212C3	269				

註：1.軸心直徑D公差：Φ11-Φ28：j6，Φ38-Φ48：k6，Φ55：m6 2.以上數值如有變更，恕不另行通知

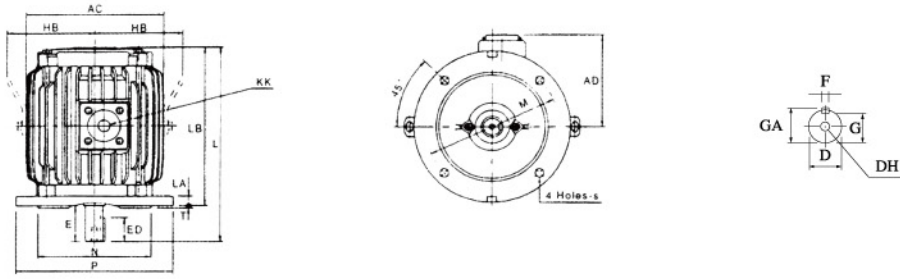

圖一

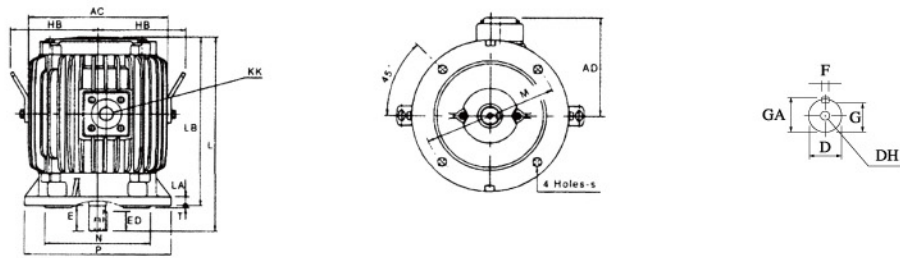

圖二

單位：mm

輸出馬力(HP)				框	圖號	AC	AD	HB	KK	L	LA	LB	LD	M	N	P	DH	S	T
2P	4P	6P	8P	號															
1	1	-	-	80	1	174	129	-	M20 X P1.5	236	12	196	-	165	130	200	M6X12	12	3.5
3-2	2	1	-	90L	2	200	142	-		322	12	272	-	165	130	200	M8X16	12	3.5
-	3	2	1	100L	1	219	151	140	M20 X P1.5	322	16	262	-	215	180	250	M10X20	14.5	4.0
5	5	3	2	112M	2	238	161	150		376	16	316	-	215	180	250		14.5	4.0
7.5-10	7.5	5	3	132S	1	273	178.5	168	M20 X P1.5	393	20	313	-	265	230	300	M12X24	14.5	4.0
-	10	7.5	5	132M						431	20	351	-						
15-20	15	10	7.5	160M	3	334	217	217	M32 X P1.5	535	20	415	-	300	250	350	M16X32	18.5	5
25	20	15	10	160L						569		459	-						5
-	25-30	20	15	180MC						382	242	241	580						20

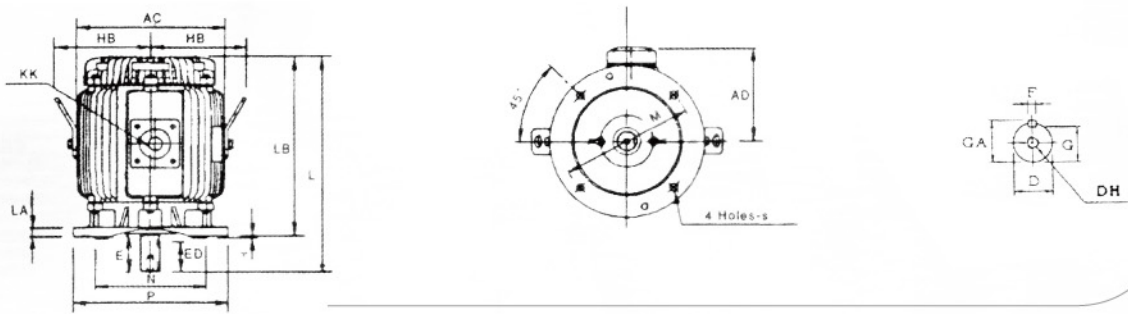

圖三

單位：mm

輸出馬力(HP)				框	圖號	軸 端							軸 承		概略重量
2P	4P	6P	8P	號		D	E	ED	EE	F	G	GA	負載側	反負載側	
1	1	-	-	80	1	19	40	25	-	6	15.5	21.5	6204ZZC3	6203ZZC3	17.5
3-2	2	1	-	90L	2	24	50	32	-	8	20.0	27.0	6205ZZC3	6204ZZC3	26
-	3	2	1	100L	1	28	60	40	-	8	24.0	31.0	6206ZZC3	6205ZZC3	36
5	5	3	2	112M	2	28	60	40	-	8	24.0	31.0	6306ZZC3	6305ZZC3	48
7.5-10	7.5	5	3	132S	1	38	80	64	-	10	33.0	41.0	6308ZZC3	6306ZZC3	72
-	10	7.5	5	132M									6308ZZC3	6306ZZC3	83
15-20	15	10	7.5	160M	3	42	110	80	-	12	37.0	45.0	6309ZZC3	6307ZZC3	121
25	20	15	10	160L									6309ZZC3	6307ZZC3	151
-	25-30	20	15	180MC									48	110	80

註：1.軸心直徑D公差：Φ19-Φ28：j6，Φ38-Φ48：k6，Φ55：m6 2.引導直徑N公差：h7 3.以上數值如有變更，恕不另行通知

