

# MH 高溫排煙馬達

**High Temperature Resistant  
Low Voltage Three-phase Squirrel-Cage Induction Motor**

Certified by TÜV SÜD PSB: 2 hours at 300°C and 400°C

Complied with BS 7346:Part 2:1990

"Specification for powered smoke and heat exhaust ventilators"

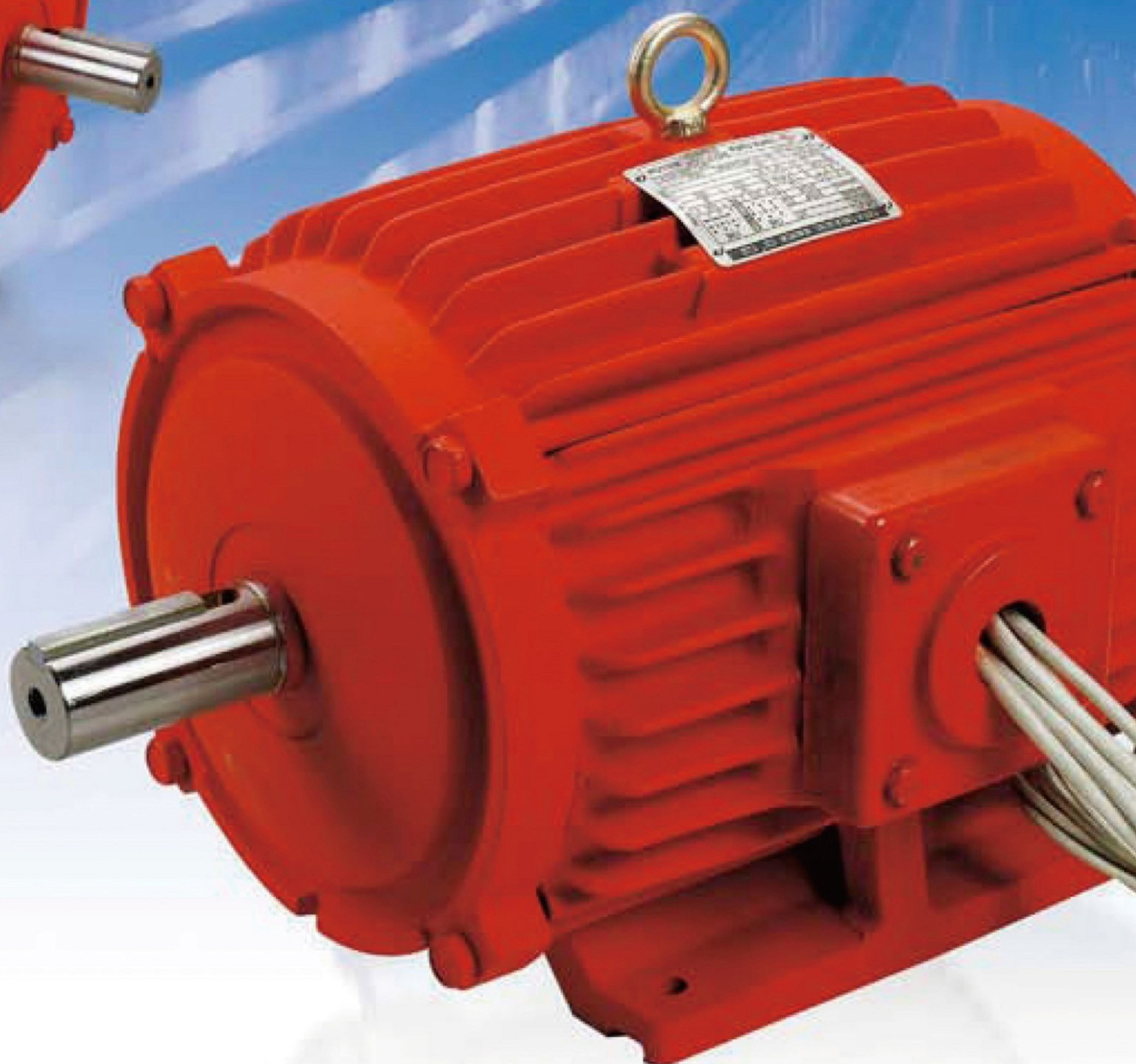
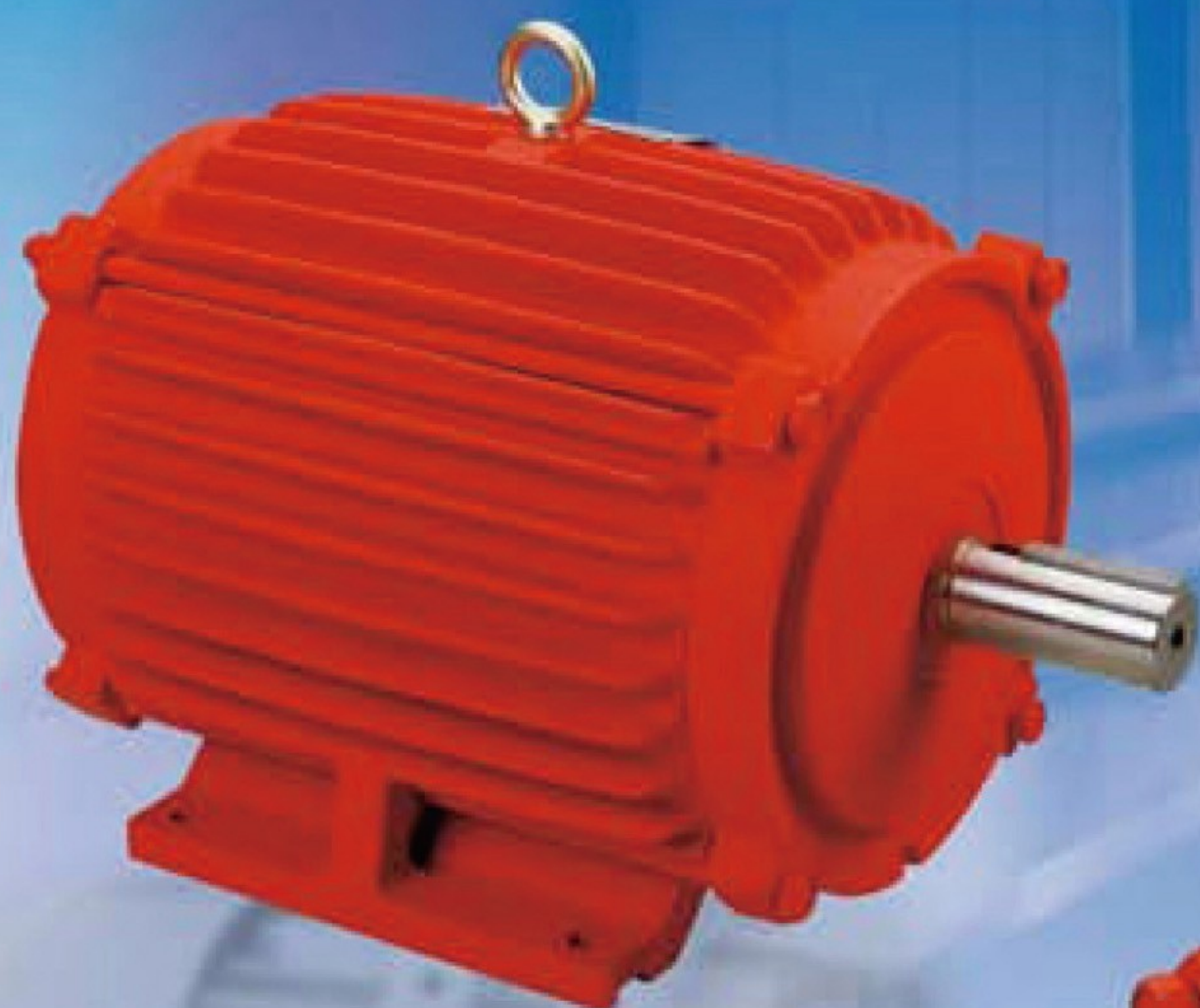

**High Efficiency  
IP44 / IP55 Protection  
IEC Dimension  
Low noise**



## Introduction

High Temperature Resistant Motors are specially designed for demanding and critical applications, such as fire emergencies in built-up areas. These motors play a life-saving role in the swift extraction and clearance of smoke and toxic fumes at high temperatures during emergencies to reduce casualties as well as facilitate the rescue operations.

These motors are compliant to BS 7346 : Part 2 : 1990 "Specifications for powered smoke and heat exhaust ventilators."

These motors are also built to comply with the requirements for European "CE" marking and International Electrotechnical Commission - IEC 60034 ( included 60034-1, 60034-5, 60034-7, 60034-8, 60034-9, 60034-11,60034-12 and 60034-14 ). Compliance with IEC60034 indicates that these motors also comply with many standards from other countries that are based on IEC60034

### **Class of performance in accordance to BS 7346 : Part 2 : 1990 Specifications for powered smoke and heat exhaust ventilators**

| Class | Temperature (°C) | Duration(hr)                          |
|-------|------------------|---------------------------------------|
| A     | 150              | 5                                     |
| B     | 250              | 2                                     |
| C     | 300              | 0.5                                   |
| D     | 300              | 1                                     |
| E     | 400              | 2                                     |
| F     | 600              | 1.5                                   |
| G     | 650              | 1                                     |
| H     | 840              | Achieved in 0.5hr (no rated duration) |

### **Time Rating**

Continuous rating S1 to IEC 60034 , BS 4999 and AS 1359 part 30 with follow-up emergency rating to 250°C for 180 mins, 300°C for 60 mins or even up to 400°C for 60 mins in accordance to BS 7346 : Part 2 : 1990

### **Bearing and Lubrication System**

Anti-friction ball-bearings with heat resistant silicon thickened grease.

### **Finish**

Phenolic rustproof base plus lacquer surface finish painting in red colour.

### **Altitude**

Standard motros : Max 1,000m above sea-level. Special requirements can be made upon request.



- 高溫排煙馬達應用於火災發生於建築物內時，能快速排出高溫濃煙及有毒氣體，在逃生過程中，扮演極重要之保命設備。
- 高溫排煙馬達設計及製造符合BS 7346 Part 2，1990 動力煙熱排放通風機規範。
- 符合CE Mark 認證及IEC60034  
(包括60034-1，60034-5，60034-7，60034-8，60037-9，60034-12，60034-14)
- **運轉時間：**  
在250度，運轉2小時，符合IEC 60034，BS 4999，AS 1359 part 30 規範。  
在300度，運轉1小時；或在400度，運轉2小時，符合BS 7346 part 2，1990
- **框架與托架：**  
框架與托架由鑄鐵製成，抗蝕性優良，馬達壽命長。
- **定子繞組與絕緣系統：**  
定子採用高級絕緣冷軋矽鋼片積片而成，適用高效率。  
定子繞組採用耐高溫瓷釉塗層銅線及H級絕緣系統。  
出口線採用耐熱矽橡膠絕緣電線。
- **轉子組立：**  
轉子採用低耗損的高級電磁鋼板積片製成轉子。  
由高導電率鋁壓力鑄造製成，端環與鋁葉一體成型。  
轉子經過動平衡校正，表面經過防鏽處理。
- **軸承與潤滑系統：**  
抗磨擦滾珠軸承，使用耐熱矽質或氟素化合物油脂。
- **軸：**  
軸的材料為中碳鋼S45C (JIS G4051)。
- **銘牌：**  
由耐蝕不鏽鋼製成。
- **塗裝噴漆：**  
表面噴防鏽漆，再噴耐高溫紅色面漆。
- **適用海拔高度：**  
適用海拔高度在1000m以下。
- IP44/IP54/IP55



## PERFORMANCE DATA

60Hz

| Rate Power |     | Pole | Rated | Frame  | Current           |                   | Efficiency |      |      | Power Factor |      |      | Torque            |        |         | M of IJ             |
|------------|-----|------|-------|--------|-------------------|-------------------|------------|------|------|--------------|------|------|-------------------|--------|---------|---------------------|
| KW         | HP  |      | (rpm) |        | INL<br>220<br>(A) | IFL<br>380<br>(A) | 100%       | 75%  | 50%  | 100%         | 75%  | 50%  | Full load<br>(Nm) | Locked | Maximum | (Kgm <sup>2</sup> ) |
| 0.75       | 1   | 2    | 3335  | 80     | 2.91              | 1.7               | 76.5       | 76.5 | 73.5 | 88.0         | 82.5 | 73.0 | 0.216             | 250    | 300     | 0.005               |
|            |     | 4    | 1710  | 80     | 3.50              | 2.0               | 77.0       | 75.5 | 71.5 | 78.0         | 68.5 | 55.5 | 0.430             | 290    | 300     | 0.009               |
|            |     | 6    | 1130  | 90L    | 3.55              | 2.1               | 76.5       | 76.0 | 72.5 | 72.0         | 63.0 | 50.0 | 0.642             | 200    | 250     | 0.017               |
| 1.5        | 2   | 2    | 3395  | 90L    | 5.53              | 3.2               | 80.0       | 80.5 | 78.0 | 88.5         | 83.5 | 73.5 | 0.428             | 320    | 330     | 0.0100              |
|            |     | 4    | 1735  | 90L    | 6.00              | 3.5               | 80.1       | 79.5 | 76.5 | 80.5         | 72.5 | 61.0 | 0.815             | 250    | 300     | 0.0170              |
|            |     | 6    | 1130  | 100L   | 6.60              | 3.9               | 77.0       | 77.5 | 74.5 | 77.0         | 69.5 | 58.0 | 1.285             | 200    | 240     | 0.0330              |
| 2.2        | 3   | 2    | 3425  | 90L    | 7.68              | 4.6               | 84.0       | 84.5 | 83.5 | 91.0         | 87.5 | 80.0 | 0.636             | 320    | 370     | 0.0150              |
|            |     | 4    | 1735  | 100L   | 8.70              | 5.0               | 84.0       | 82.5 | 80.0 | 86.0         | 80.5 | 70.5 | 1.270             | 240    | 280     | 0.0330              |
|            |     | 6    | 1145  | 112M   | 9.24              | 5.4               | 81.0       | 81.0 | 78.5 | 78.5         | 71.5 | 60.5 | 1.902             | 190    | 260     | 0.0590              |
| 3.7        | 5   | 2    | 3485  | 112M   | 12.9              | 7.4               | 84.5       | 86.0 | 83.5 | 90.0         | 88.5 | 82.0 | 1.041             | 240    | 340     | 0.038               |
|            |     | 4    | 1745  | 112M   | 14.5              | 7.8               | 87.0       | 85.5 | 83.0 | 85.0         | 80.0 | 70.0 | 2.080             | 220    | 200     | 0.059               |
|            |     | 6    | 1160  | 132M   | 15.1              | 8.7               | 84.0       | 83.0 | 79.5 | 77.0         | 69.5 | 58.0 | 3.129             | 180    | 230     | 0.151               |
| 5.5        | 7.5 | 2    | 3490  | 132S   | 18.9              | 11.0              | 86.5       | 86.0 | 84.0 | 90.0         | 88.5 | 83.5 | 1.560             | 210    | 270     | 0.0650              |
|            |     | 4    | 1750  | 132S   | 20.1              | 11.6              | 86.0       | 85.5 | 83.5 | 86.0         | 80.5 | 70.0 | 3.129             | 240    | 300     | 0.1040              |
|            |     | 6    | 1150  | 132M   | 21.5              | 12.8              | 85.5       | 85.0 | 82.5 | 80.0         | 73.5 | 62.5 | 4.734             | 210    | 320     | 0.2170              |
| 7.5        | 10  | 2    | 3475  | 132S   | 24.6              | 14.2              | 88.0       | 88.5 | 87.0 | 90.5         | 89.0 | 84.5 | 2.089             | 220    | 260     | 0.0760              |
|            |     | 4    | 1750  | 132M   | 25.1              | 14.5              | 89.5       | 89.0 | 87.5 | 89.0         | 85.5 | 77.0 | 4.172             | 240    | 290     | 0.1430              |
|            |     | 6    | 1170  | 160M   | 27.3              | 16.2              | 86.5       | 85.5 | 82.5 | 83.0         | 77.5 | 68.0 | 6.204             | 270    | 300     | 0.4000              |
| 11         | 15  | 2    | 3535  | 160M   | 36.9              | 21.4              | 88.0       | 87.5 | 85.0 | 90.5         | 88.5 | 83.5 | 3.080             | 240    | 310     | 0.1470              |
|            |     | 4    | 1760  | 160M   | 36.1              | 21.2              | 90.5       | 89.5 | 87.5 | 88.5         | 85.5 | 78.0 | 6.204             | 240    | 290     | 0.3150              |
|            |     | 6    | 1165  | 160L   | 40.0              | 22.5              | 89.0       | 88.5 | 86.5 | 82.5         | 76.5 | 65.5 | 9.346             | 290    | 320     | 0.5880              |
| 15         | 20  | 2    | 3515  | 160M   | 48.1              | 27.8              | 88.5       | 88.0 | 86.0 | 92.0         | 91.5 | 88.5 | 4.130             | 230    | 260     | 0.1830              |
|            |     | 4    | 1760  | 160L   | 49.1              | 29.0              | 91.0       | 91.0 | 90.0 | 89.5         | 86.0 | 79.0 | 8.248             | 240    | 270     | 0.3810              |
|            |     | 6    | 1165  | 180MC  | 50.9              | 29.6              | 90.5       | 91.0 | 90.5 | 85.0         | 82.5 | 76.0 | 12.461            | 210    | 230     | 1.2330              |
| 18.5       | 25  | 2    | 3515  | 160L   | 58.5              | 35.1              | 90.0       | 90.0 | 88.0 | 93.0         | 92.5 | 89.5 | 5.163             | 260    | 270     | 0.2370              |
|            |     | 4    | 1765  | 180MC  | 62.1              | 36.3              | 91.5       | 92.0 | 91.0 | 87.5         | 85.0 | 78.5 | 10.370            | 230    | 260     | 0.5710              |
|            |     | 6    | 1170  | 180LC  | 64.0              | 37.2              | 91.0       | 91.5 | 90.5 | 84.0         | 80.5 | 73.5 | 15.510            | 210    | 240     | 1.6100              |
| 22         | 30  | 2    | 3530  | 180MC  | 70.2              | 41.6              | 91.5       | 91.0 | 88.5 | 91.5         | 90.0 | 86.0 | 6.169             | 230    | 270     | 0.2830              |
|            |     | 4    | 1765  | 180MC  | 73.2              | 42.1              | 92.0       | 91.5 | 90.5 | 86.0         | 81.5 | 72.5 | 12.373            | 270    | 300     | 0.7440              |
|            |     | 6    | 1170  | 180LC  | 75.5              | 44.3              | 92.0       | 92.5 | 92.0 | 84.5         | 82.5 | 76.5 | 18.612            | 210    | 240     | 1.9200              |
| 30         | 40  | 2    | 3545  | 180LC  | 95.8              | 54.9              | 90.0       | 89.0 | 86.5 | 89.0         | 88.0 | 84.5 | 8.190             | 160    | 230     | 0.5210              |
|            |     | 4    | 1765  | 180LC  | 96.2              | 55.8              | 92.5       | 92.0 | 91.0 | 88.0         | 85.5 | 80.0 | 16.404            | 260    | 280     | 1.2640              |
| 37         | 50  | 2    | 3545  | 200LA  | 119               | 69.9              | 91.5       | 91.0 | 89.0 | 90.0         | 89.5 | 86.5 | 10.238            | 160    | 230     | 0.6330              |
|            |     | 4    | 1770  | 200LC  | 124               | 71.6              | 92.0       | 93.0 | 92.0 | 86.0         | 85.5 | 81.5 | 20.504            | 240    | 250     | 1.422               |
| 45         | 60  | 4    | 1765  | 200LC  | 144               | 83.1              | 92.0       | 93.0 | 92.5 | 89.0         | 87.0 | 84.0 | 24.675            | 210    | 230     | 1.643               |
|            |     | 6    | 1180  | 225SC  | 148               | 85.4              | 92.5       | 93.0 | 92.0 | 86.0         | 84.0 | 76.5 | 36.908            | 220    | 220     | 3.023               |
| 55         | 75  | 4    | 1775  | 225SC  | 184               | 106               | 92.5       | 93.5 | 92.0 | 86.5         | 85.5 | 79.5 | 30.670            | 180    | 200     | 1.979               |
|            |     | 6    | 1175  | A250SC | 185               | 107               | 93.0       | 93.5 | 93.0 | 85.5         | 85.0 | 78.0 | 46.331            | 200    | 200     | 4.929               |
| 75         | 100 | 4    | 1775  | A250SC | 235               | 135               | 93.5       | 92.5 | 91.0 | 89.0         | 87.0 | 83.0 | 40.893            | 170    | 270     | 4.226               |

Date are subjected to revisions without any prior notice.



## 規 範 表

| 項 目 |         | 標 準 規 範  |
|-----|---------|--|
| 規 格 | 種 類     | 低壓三相鼠籠式感應電動機   |
|     | 設 計 依 據 | 英國工業標準(BS) 澳洲標準(AS), 中國國家標準 (CNS14400) 符合電動機規範章節16221 要求   |
|     | 電 壓     | 額定電壓 220V / 380V / 415V / 440V / 460V  |
|     | 頻 率     | 額定頻率 50 HZ 或 60 HZ\  |
|     | 輸 出 馬 力 | 2P:1~100HP 4P:1~100HP 6P:1~100HP 8P:1~100HP  |
|     | 同 步 轉 速 | 3600~750 R. P. M.  |
|     | 時 間 額 定 | 連續使用額定，使用係數S.F.1.0.(50 HZ)/S.F.1.15(60HZ)<br>緊急下額定：等級D=300 C，90分鐘 D=300 C,60分鐘，D=300 C,120分鐘 D=400 C,120分鐘 |
|     | 框 號     | 80~250SC   |
|     | 保 護 方 式 | 全密閉（表面風冷）  |
|     | 絕 緣 等 級 | H級   |
| 適 用 | 電 源     | 電壓變動率：±5%以內  |
|     | 場 所     | 一般屋內   |
|     | 溼 度     | 相對濕度90%以下（但不能凝結）   |
|     | 標 高     | 海拔 1000 公尺以下   |
|     | 帶 動 方 式 | 風扇直結傳動   |
|     | 轉 向     | 雙轉向  |
|     | 起 動 方 式 | 全壓直接啓動或 Y-△啓動  |



圖一

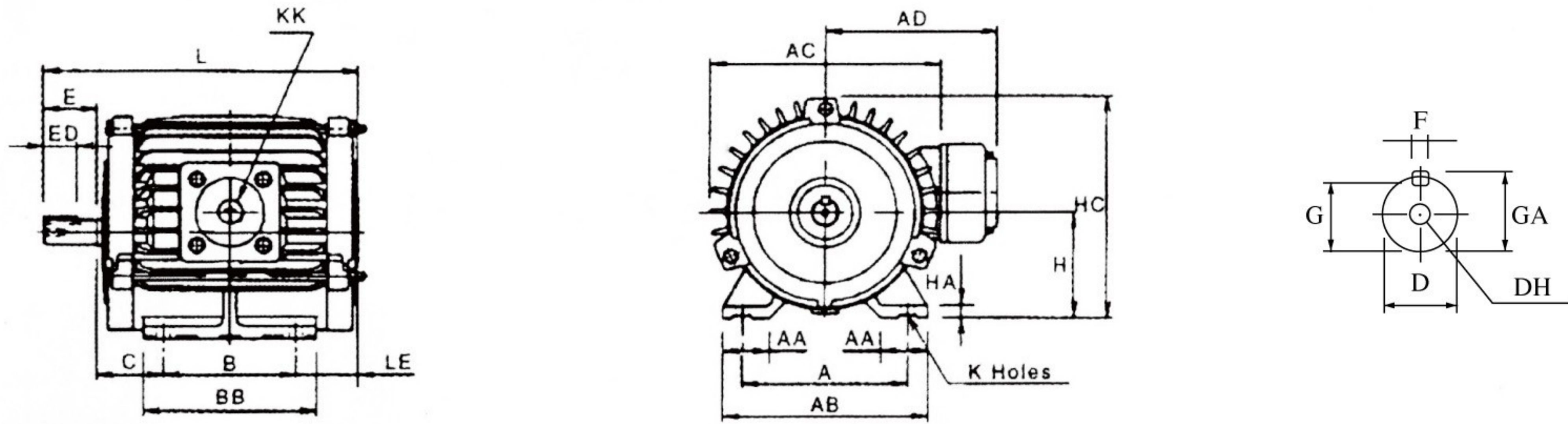

圖二

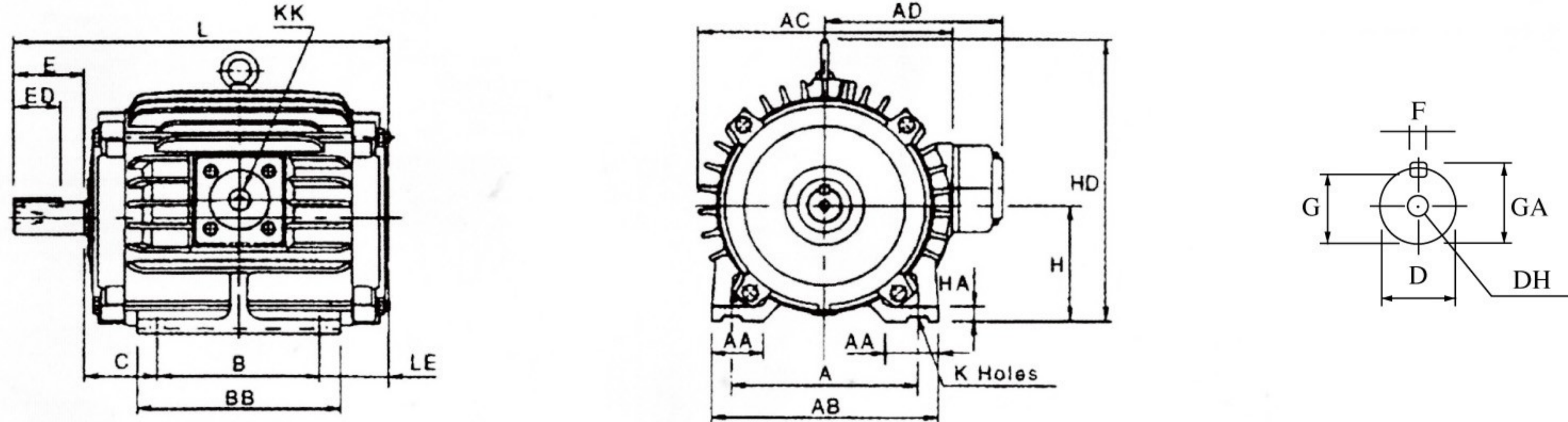

單位：mm

| 輸出馬力(HP) |       |       |       | 框號    | 圖號 | A   | AA   | AB  | AC  | AD    | B   | BA  | BB  | C   | H   | HA   | HC  | HD  | DH     |
|----------|-------|-------|-------|-------|----|-----|------|-----|-----|-------|-----|-----|-----|-----|-----|------|-----|-----|--------|
| 2P       | 4P    | 6P    | 8P    |       |    | A   | AA   | AB  | AC  | AD    | B   | BA  | BB  | C   | H   | HA   | HC  | HD  | DH     |
| 1        | 1     |       |       | 80    | 1  | 125 | 35.5 | 155 | 174 | 129   | 100 | -   | 130 | 50  | 80  | 9.0  | 168 | -   | M6X12  |
| 2-3      | 2     | 1     |       | 90L   |    | 140 | 35.5 | 170 | 200 | 142   | 125 | -   | 150 | 56  | 90  | 10.0 | 190 |     | M8X16  |
|          | 3     | 2     | 1     | 100L  | 2  | 160 | 45.0 | 195 | 219 | 151   | 140 | -   | 175 | 63  | 100 | 12.5 | -   | 243 | M10X20 |
| 5        | 5     | 3     | 2     | 112M  |    | 190 | 45.0 | 224 | 238 | 161   | 140 | -   | 175 | 70  | 112 | 14.0 | -   | 265 |        |
| 7.5-10   | 7.5   | 5     | 3     | 132S  |    | 216 | 45.0 | 250 | 273 | 178.5 | 140 | -   | 175 | 89  | 132 | 16.0 | -   | 310 | M12X24 |
|          | 10    | 7.5   | 5     | 132M  |    | 216 | 45.0 | 250 | 273 | 178.5 | 178 | -   | 212 | 89  | 132 | 16.0 | -   | 310 |        |
| 15-20    | 15    | 10    | 7.5   | 160M  | 3  | 254 | 50   | 300 | 334 | 217   | 210 | -   | 250 | 108 | 160 | 18.0 | -   | 377 | M16X32 |
| 25       | 20    | 15    | 10    | 160L  |    | 254 | 50   | 300 | 334 | 217   | 254 | -   | 300 | 108 | 160 | 18.0 | -   | 377 |        |
|          | 25-30 | 20    | 15    | 180MC |    | 279 | 75   | 355 | 382 | 242   | 241 | -   | 297 | 121 | 180 | 20.0 | -   | 421 | M20X40 |
|          | 40    | 25-30 | 20    | 180LC |    |     |      |     |     | 279   | -   | 335 |     |     |     |      |     |     |        |
| 50-60    |       |       |       | 200LA |    | 318 | 80   | 400 | 420 | 265   | 305 | -   | 365 | 133 | 200 | 25.0 | -   | 469 |        |
|          | 50-60 | 40-50 | 25-30 | 200LC |    |     |      |     |     |       |     |     |     |     |     |      |     |     |        |

圖三

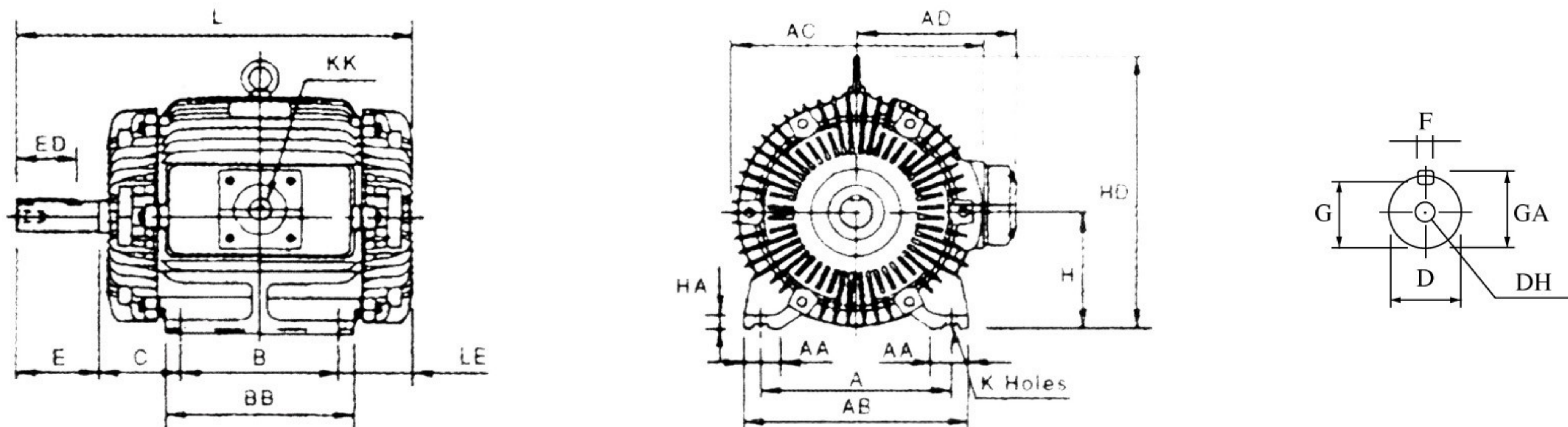

單位：mm

| 圖號 | K    | KK       | L   | LE  | 軸端  |     |     |    |      |      |          | 軸承       |          | 概略重量<br>KGS |
|----|------|----------|-----|-----|-----|-----|-----|----|------|------|----------|----------|----------|-------------|
|    |      |          |     |     | D   | E   | ED  | EE | F    | G    | GA       | 負載側      | 反負載側     |             |
| 1  | 10   | M20XP1.5 | 236 | 46  | 19  | 40  | 25  | -  | 6    | 15.5 | 21.5     | 6204ZZC3 | 6203ZZC3 | 15          |
|    |      |          | 283 | 52  | 24  | 50  | 32  | -  | 8    | 20.0 | 27.0     | 6205ZZC3 | 6204ZZC3 | 24          |
| 2  | 12   | M20XP1.5 | 322 | 59  | 28  | 60  | 40  | -  | 8    | 24.0 | 31.0     | 6206ZZC3 | 6205ZZC3 | 31          |
|    |      |          | 336 | 66  | 28  | 60  | 40  | -  | 8    | 24.0 | 31.0     | 6306ZZC3 | 6305ZZC3 | 43          |
|    |      | M25XP1.5 | 393 | 84  | 38  | 80  | 64  | -  | 10   | 33.0 | 41.0     | 6308ZZC3 | 6306ZZC3 | 67          |
|    |      |          | 431 | 84  | 38  | 80  | 64  | -  | 10   | 33.0 | 41.0     | 6308ZZC3 | 6306ZZC3 | 78          |
| 3  | 14.5 | M32XP1.5 | 525 | 97  | 42  | 110 | 80  | -  | 12   | 37   | 45       | 6309ZZC3 | 6307ZZC3 | 113         |
|    |      |          | 569 | 97  | 42  | 110 | 80  | -  | 12   | 37   | 45       | 6309ZZC3 | 6307ZZC3 | 143         |
|    |      | 580      | 108 | 48  | 110 | 80  | -   | 14 | 42.5 | 51.5 | 6311ZZC3 | 6310ZZC3 | 165/185  |             |
|    |      | 618      | 108 | 55  | 110 | 80  | -   | 16 | 49   | 59   | 6312ZZC3 | 6310ZZC3 | 220      |             |
|    | 18.5 | M50XP1.5 | 715 | 135 | 55  | 110 | 80  | -  | 16   | 49   | 59       | (6312C3) | (6212C3) | 269         |
|    |      |          |     |     | 60  | 140 | 110 | -  | 18   | 53   | 64       | 6314C3   | 6212C3   | 269         |

註：1.軸心直徑D公差：Φ11-Φ28：j6，Φ38-Φ48：k6，Φ55：m6 2.以上數值如有變更，恕不另行通知



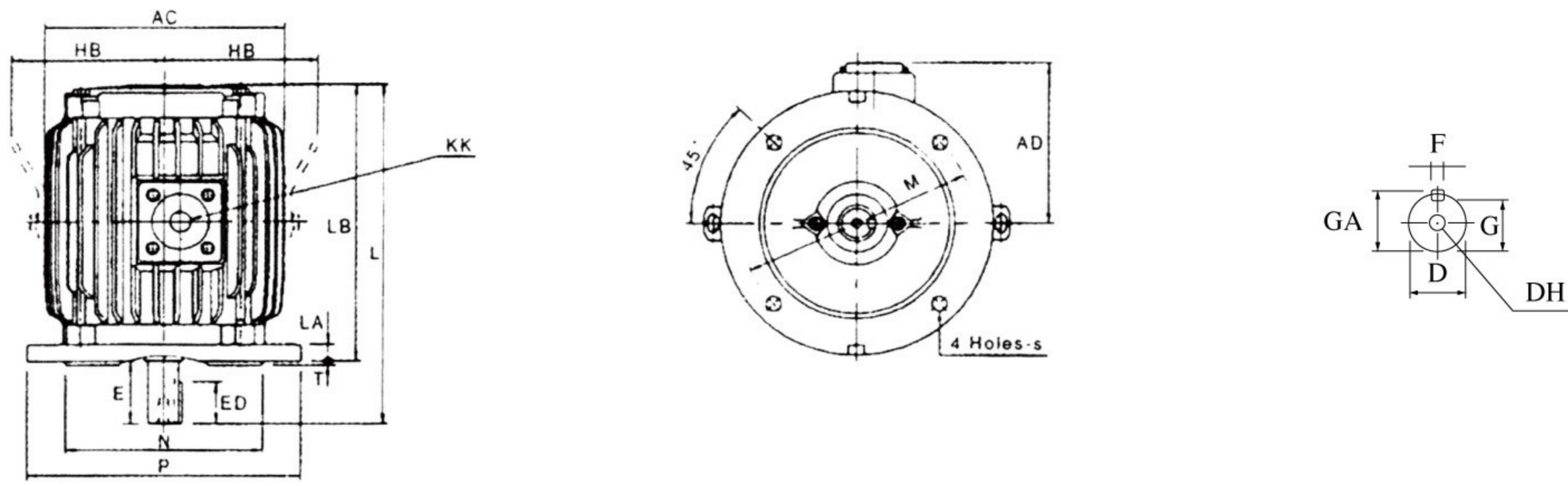

圖一

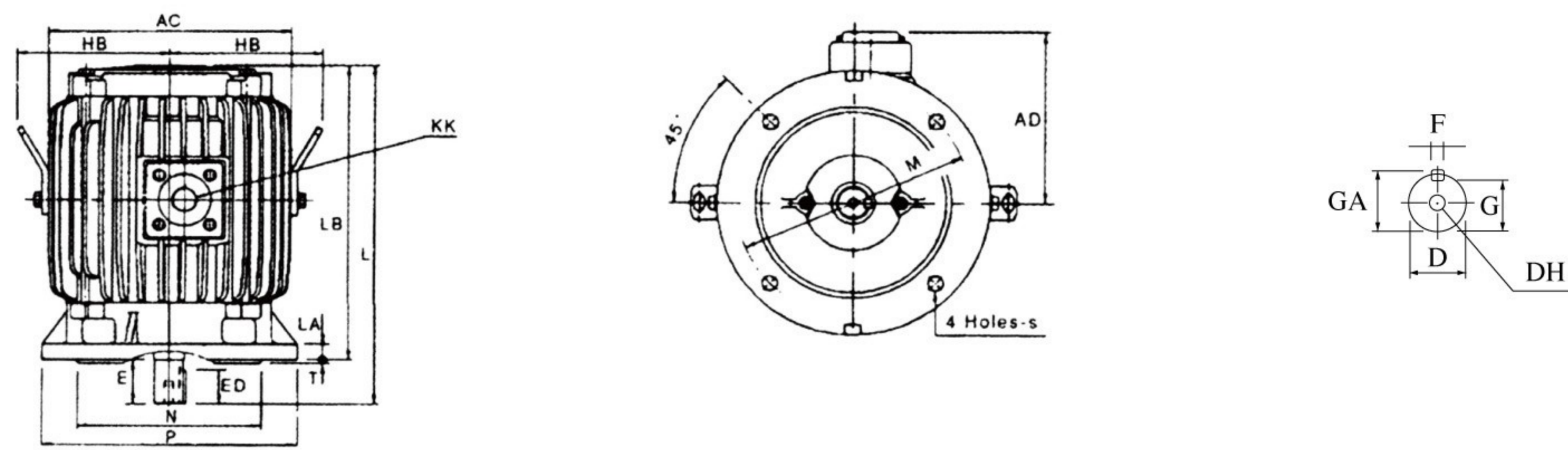

圖二

單位：mm

| 輸出馬力(HP) |       |     |     | 框號    | 圖號 | AC  | AD    | HB  | KK         | L   | LA | LB  | LD | M   | N   | P   | DH     | S    | T   |
|----------|-------|-----|-----|-------|----|-----|-------|-----|------------|-----|----|-----|----|-----|-----|-----|--------|------|-----|
| 2P       | 4P    | 6P  | 8P  |       |    |     |       |     |            |     |    |     |    |     |     |     |        |      |     |
| 1        | 1     | -   | -   | 80    | 1  | 174 | 129   | -   | M20 X P1.5 | 236 | 12 | 196 | -  | 165 | 130 | 200 | M6X12  | 12   | 3.5 |
| 3-2      | 2     | 1   | -   | 90L   | 2  | 200 | 142   | -   |            | 322 | 12 | 272 | -  | 165 | 130 | 200 | M8X16  | 12   | 3.5 |
| -        | 3     | 2   | 1   | 100L  | 1  | 219 | 151   | 140 | M20 X P1.5 | 322 | 16 | 262 | -  | 215 | 180 | 250 | M10X20 | 14.5 | 4.0 |
| 5        | 5     | 3   | 2   | 112M  | 2  | 238 | 161   | 150 |            | 376 | 16 | 316 | -  | 215 | 180 | 250 |        | 14.5 | 4.0 |
| 7.5-10   | 7.5   | 5   | 3   | 132S  | 1  | 273 | 178.5 | 168 | M20 X P1.5 | 393 | 20 | 313 | -  | 265 | 230 | 300 | M12X24 | 14.5 | 4.0 |
| -        | 10    | 7.5 | 5   | 132M  |    |     |       |     |            | 431 | 20 | 351 | -  |     |     |     |        |      |     |
| 15-20    | 15    | 10  | 7.5 | 160M  | 3  | 334 | 217   | 217 | M32 X P1.5 | 535 | 20 | 415 | -  | 300 | 250 | 350 | M16X32 | 18.5 | 5   |
| 25       | 20    | 15  | 10  | 160L  |    |     |       |     |            | 569 |    | 459 | -  |     |     |     |        |      | 5   |
| -        | 25-30 | 20  | 15  | 180MC |    |     |       |     |            | 580 | 20 | 470 | -  |     |     |     |        |      | 300 |

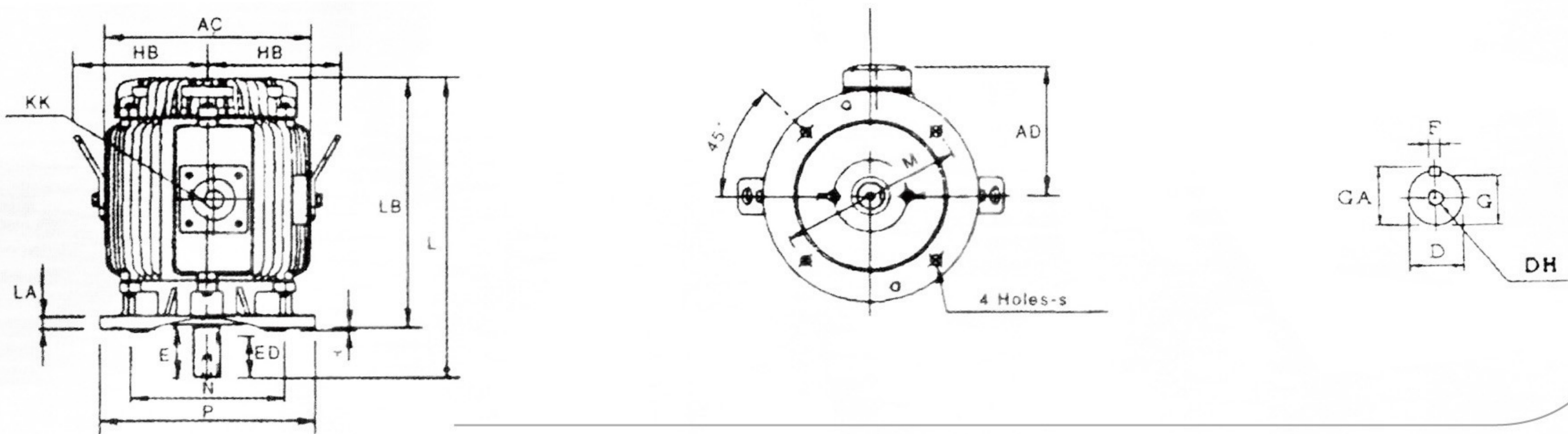

圖三

單位：mm

| 輸出馬力(HP) |       |     |     | 框號    | 圖號 | 軸端 |     |    |    |    |      | 軸承   |          | 概略重量     |      |
|----------|-------|-----|-----|-------|----|----|-----|----|----|----|------|------|----------|----------|------|
| 2P       | 4P    | 6P  | 8P  |       |    | D  | E   | ED | EE | F  | G    | GA   | 負載側      |          | 反負載側 |
| 1        | 1     | -   | -   | 80    | 1  | 19 | 40  | 25 | -  | 6  | 15.5 | 21.5 | 6204ZZC3 | 6203ZZC3 | 17.5 |
| 3-2      | 2     | 1   | -   | 90L   | 2  | 24 | 50  | 32 | -  | 8  | 20.0 | 27.0 | 6205ZZC3 | 6204ZZC3 | 26   |
| -        | 3     | 2   | 1   | 100L  | 1  | 28 | 60  | 40 | -  | 8  | 24.0 | 31.0 | 6206ZZC3 | 6205ZZC3 | 36   |
| 5        | 5     | 3   | 2   | 112M  | 2  | 28 | 60  | 40 | -  | 8  | 24.0 | 31.0 | 6306ZZC3 | 6305ZZC3 | 48   |
| 7.5-10   | 7.5   | 5   | 3   | 132S  | 1  | 38 | 80  | 64 | -  | 10 | 33.0 | 41.0 | 6308ZZC3 | 6306ZZC3 | 72   |
| -        | 10    | 7.5 | 5   | 132M  |    |    |     |    |    |    |      |      | 6308ZZC3 | 6306ZZC3 | 83   |
| 15-20    | 15    | 10  | 7.5 | 160M  | 3  | 42 | 110 | 80 | -  | 12 | 37.0 | 45.0 | 6309ZZC3 | 6307ZZC3 | 121  |
| 25       | 20    | 15  | 10  | 160L  |    |    |     |    |    |    |      |      | 6309ZZC3 | 6307ZZC3 | 151  |
| -        | 25-30 | 20  | 15  | 180MC |    |    |     |    |    |    |      |      | 48       | 110      | 80   |

註：1.軸心直徑D公差：Φ19-Φ28：j6，Φ38-Φ48：k6，Φ55：m6 2.引導直徑N公差：h7 3.以上數值如有變更，恕不另行通知



